

# TRIKKE<sup>TM</sup> *colt*



## ***Owner's Manual***



**CAREFULLY READ THE  
WARNINGS, SAFETY  
INFORMATION AND  
RIDING TIPS.**



Thank you for purchasing a Trikke™ product. This manual is designed to help you get the most out of your Trikke Electric Vehicle. The warnings and instructions have been carefully prepared to make your experience safer and more enjoyable. Use common sense when riding. Read and understand the Safety Information section on page 17.



**READ AND UNDERSTAND** the sections of assembly, maintenance and safety in the owner's manual before riding. Always follow the directions and read all warnings.

- **Always use proper safety equipment when riding the Trikke EV** including a helmet approved by ANSI, Snell, CPSC, ASTM or DIN EN1078. Use proper footwear and make sure that shoes with laces are properly tied before riding.
- **Avoid water, bumps, gravel, sand, cracks, uneven surfaces or obstacles** that may suddenly block your way or cause you to lose control. The Trikke EV is not intended for off road use. Avoid using at night.
- **Riding with only one hand or no hands can be extremely dangerous.** Use both hands to hold the handlebars firmly at all times. Do not push too hard or apply uneven pressure to the two different sides of the handlebars. **Do not make sudden sharp turns or apply your body weight on the handlebars when turning.** Such actions can make the front wheel of the vehicle quickly turn to one side and causing the vehicle to “jack-knife” or stop suddenly, which can cause fall and serious injury to the rider.
- **Tricks, riding or rolling backwards and/or extreme riding are not recommended on the Trikke EV.** Riding this way you can damage the product, voiding your warranty and may result in injury or death.
- **Do not pull up on the handlebars because in doing so the rider can slip off the foot platforms, resulting in serious injury or death.** The rider must keep his weight within the area delineated by the three wheels and step on the center or frontal part of the deck, never on the back.
- **Riding down hills is not recommended, especially for novice riders.** The Trikke EV is designed primarily for use on flat, dry asphalt. Extreme caution should be used when riding on any inclined surface.
- We recommend that you do not exceed the Trikke EV **maximum rider's weigh limit of 200 lbs (91kg).**
- **A rider should be constantly on the lookout for obstacles,** debris, cracks or holes in the riding path, allowing them to be anticipated and avoided.



- **Because of the speed increase, the risk of injury and death are increased when riding with the electric motor.** Attention to the ride is a constant.
- **The braking to a full stop, at high speed, in a safe environment,** to assess the distance required to stop.
- **Be aware of low objects.** You are taller than you think when you ride the Trikke EV. Be ready to duck for tree branches, street signs, etc..
- **Whenever you ride, follow the traffic rules, including traffic signs, traffic lights and crosswalks.** Usually, you must follow the same rules as a bicycle or an electric bicycle.
- **Tire wear, puncture, or blowout may result in sudden loss of control, which can cause serious injury.** Always make sure that the tire maintenance is being done correctly.
- **Braking and locking or skidding with the rear wheels will damage the tires,** and such damage is not covered under warranty. Rider may lose control and fall when locking the wheels during braking. Control braking power by the force applied on the brake lever.
- **If you do not have the proper tools or find that you are unable to understand the assembly instructions, contact an authorized dealer** to assemble the Trikke EV for you.
- **Stop riding immediately if you suspect that some part of the vehicle is not working properly.** Inspect the vehicle to confirm what the problem is. Contact your dealer or TRIKKE Technical Support directly if you suspect that there is a malfunction or defect that affects safe operation.
- **If you do not understand how to operate the Trikke EV properly, do not use it.** Contact your dealer or Technical Support Trikke for proper training.
- **Always inspect your vehicle before each use** and make sure the handlebar clamp and folding mechanism of the arms are locked in place. Read the important assembly, operation and maintenance information in this manual.
- **Test the brakes properly before each use;** always engage both brakes equally with your weight evenly distributed over the rear wheels.





- **Children must be supervised by an adult while riding.** The parent is responsible for proper maintenance and vehicle inspection before each use. **The Trikke EV is not recommended for children under 13 years of age or less than 5 feet tall.**
- **Always use caution when you are riding close to other vehicles,** pedestrians, and especially near cars if you're riding on a street. Obey all traffic laws. Be courteous to drivers of other vehicles and pedestrians. Share the road!
- **Do not modify your Trikke EV.** Use only original Trikke parts or accessories. See limited warranty for restrictions on use of non-original parts or modifications.
- **Any modification of the electrical system will void the warranty,** to increase the speed or power of the motor.
- **The electrical system is designed to operate at specified voltage and current.** Using any other batteries than the original TRIKKE battery and charger can result in system failure. Any modification will void the warranty. Trikke Tech; Inc. is not liable for injuries and / or death or any other damages caused by such changes.
- **The Trikke EV vehicle is a lightweight, low-power electric vehicle, and may require the rider's help.** Continuous turning right and left should be applied to help the engine while on a climb.
- **The use of the electric motor will propel you to speeds you may not be accustomed to, and may be beyond your skill level.** Begin by practicing at lower speeds for your own safety.



- The Trikke EV is an electric vehicle and as such there is potential for shock or fire, if the electrical system is tampered with or exposed to conditions of high humidity, causing possible short circuit or overload of the electric system. Electrical components must be protected from conditions of high humidity and physical damage.
- Using a charger other than the original Trikke charger can cause overheating of the battery and potential risk of fire.
- **COMMON SENSE AND EDUCATION ARE VERY IMPORTANT IN THE OPERATION OF YOUR TRIKKE EV. DRIVERS SHOULD USE COURTESY WHEN USING AND SHARING THE ROADS AND SIDEWALKS. PEDESTRIANS ALWAYS HAVE THE RIGHT OF WAY. WHEN RIDING ON PUBLIC ROADWAYS, KEEP ON THE RIGHT SIDE OF THE ROAD AND REDUCE YOUR CARVING ACTION TO MINIMIZE CAUSING CONFUSION WITH THE OTHER DRIVERS ON THE SAME ROUTE.**
- **REMINDER: TRIKKE VEHICLES ARE DESIGNED TO RIDE FORWARD ONLY. PLEASE, DO NOT RIDE BACKWARDS AS THERE IS THE POSSIBILITY OF DAMAGING THE FRAME.**

# Know the Colt



\* - POWER COMPONENTS

# Assembly

## Colt - First Assembly

The Colt comes pre-assembled and only requires the mounting of the handlebar, front fork with motor assembly, and a quick check of some items before riding.

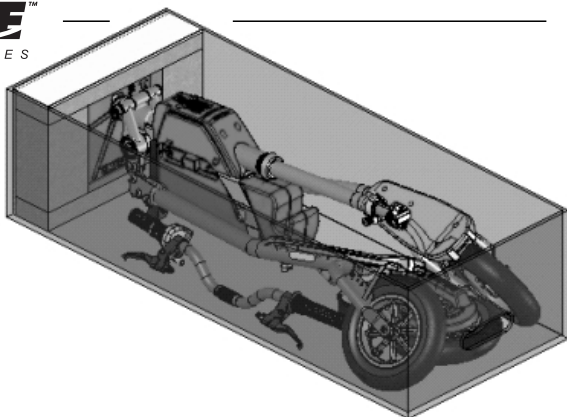

**Note:** For assembly instructions go to [www.trikke.com/tech-support/](http://www.trikke.com/tech-support/)

## STEP 1 Unfolding the Frame

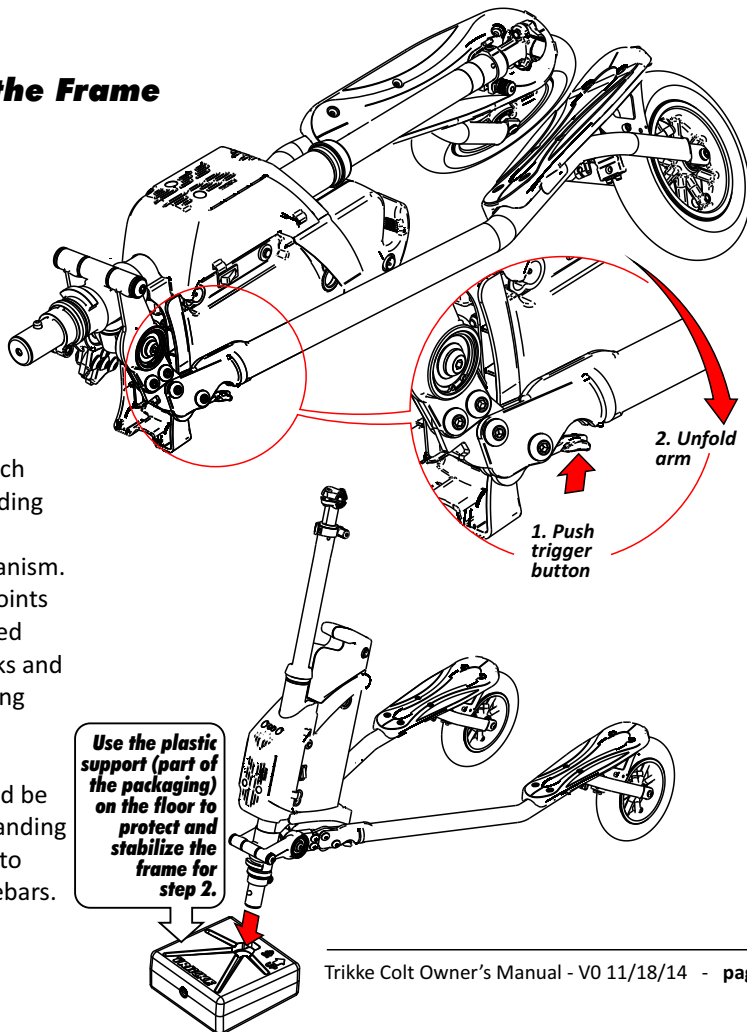

At the front of each arm there is a folding joint near the cambering mechanism. Each of the two joints has a spring loaded trigger which locks and releases the folding mechanism.

The vehicle should be in its unfolded standing position in order to attach the handlebars.

## STEP 2

### Mount the Handlebar

**2.1** - Remove the two bolts securing the stem plate to the handlebar stem using the supplied 5mm Hex wrench. Remove the plate, but keep it nearby. To ensure that the whole steering system is facing the correct direction (in the direction the vehicle will be traveling), look down by the floor where the steering column is touching the ground. The three inch fork post has a spring loaded push-pin. Rotate the handlebar stem until the pin is facing the direction the vehicle will be traveling. This is important for proper front fork/motor alignment (step 3).

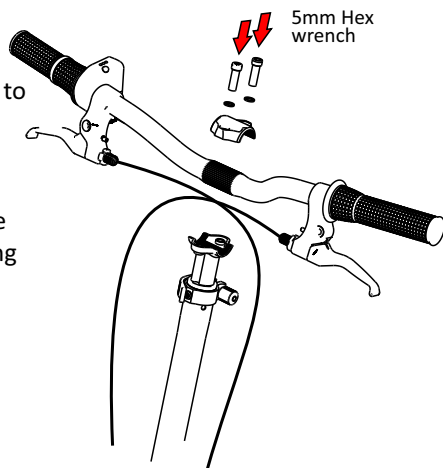

**2.2** - Position the handlebars with the brake cables like shown on the image above.

**2.3** - Once the brake cables are properly routed you can secure the handlebar. Holding the handlebars on the bottom stem plate, replace the top plate and the 2 bolts. Position the handlebar raked forward at 45° angle to the steering column, center it on the stem and tighten the 2 bolts evenly.

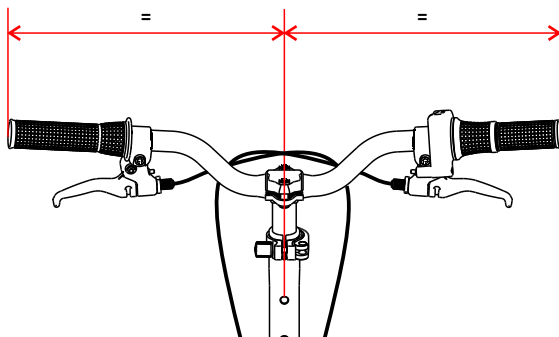
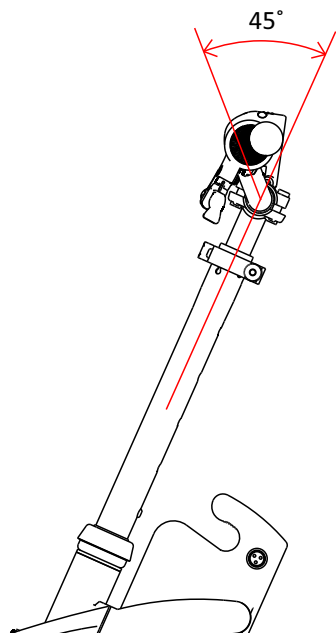



## STEP 3

### Adjusting Handlebar Height

Unlock the quick release lever to raise or lower the level of the handlebar. Notice the round holes down the back of the handle bar stem post, which provide a number of height-locking positions. A spring loaded locking pin snaps into these holes to provide a second level of safety while riding. Push the locking pin IN to release the stem post and telescope the handlebars to your preferred riding height. Once the height has been set, make sure to close the quick-release clamp.

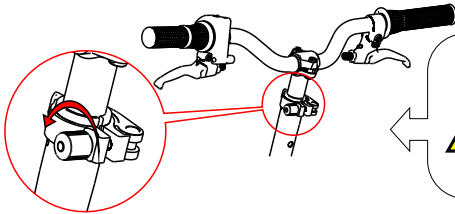
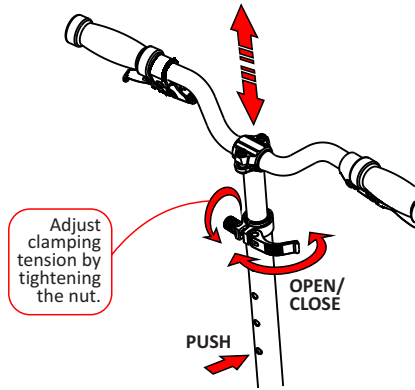

**The quick-release clamp must feel tight when closing the lever. If needed, the tension can be adjusted through the finger nut.**

## STEP 4

### Attaching and Aligning the Front Fork

Mounting the front fork assembly to the steering axle requires a 5mm Hex wrench (supplied). First, turn the vehicle upside down so the fork post (arrow right) is aiming towards the sky. You should do this procedure on a carpet or soft surface to prevent scratching the handlebars or damaging the throttle.

**4.1** - Inspecting the steering axle you will find a spring loaded locking pin. On the fork, you will also find a slot to secure the locking pin on the front face of it.

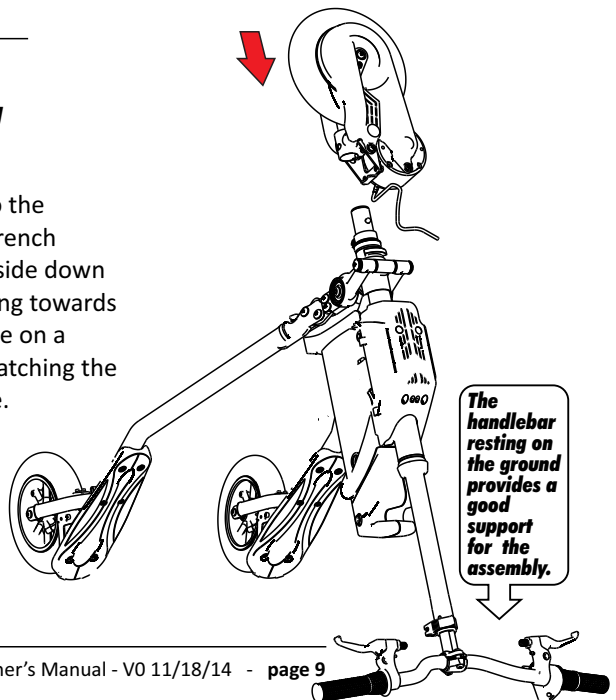

**4.2** - Fit the fork to the steering axle. The fork assembly must be first positioned 90 degrees to the working direction in order to slide it all the way in, then be turned to the final position where the push-pin will snap in the hole. See image below.

**4.3** - Depress the locking pin and slide the fork the final inch, rotating up to final position - until the locking pin snaps into the slot. "Slightly tighten" the 2 bolts at the fork clamp.

**4.4** - Alignment of front fork with handlebar:

**4.4.1** - Flip the Trikke to riding position.

**4.4.2** - Step on the vehicle, hold it with both hands on the handlebars and look down the front tube. Fine adjust the front fork

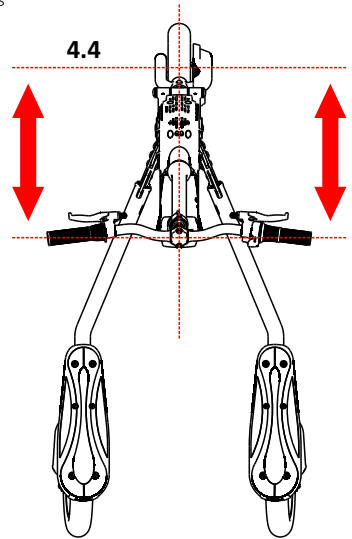

position by aligning the tire 90 degrees to the handlebar. You may ask someone to hold the front wheel while you perform the alignment.

**4.5** - Use the 5mm Hex wrench to **firmly** tighten the two bolts that secure the fork to the steering axle.

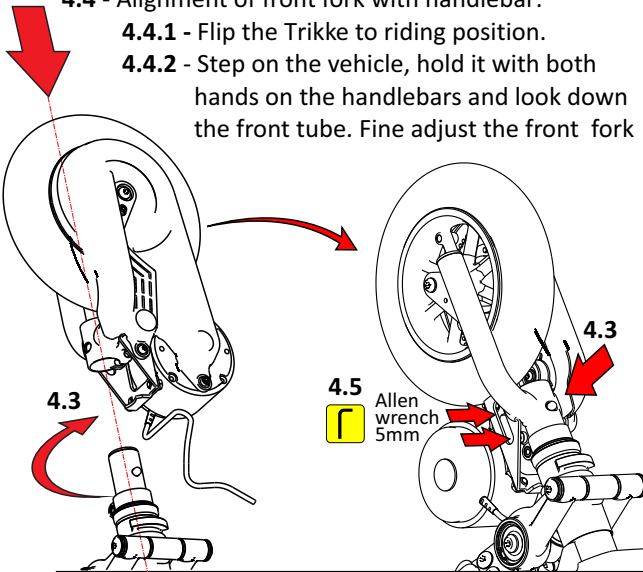

## STEP 5 Connecting the Motor Cable to the Controller

**5.1** - Route the motor cable and use the supplied plastic tie to secure it to the frame as shown on the image. **This is very important in order to allow enough slack on the cable while turning the wheel left-and-right.**

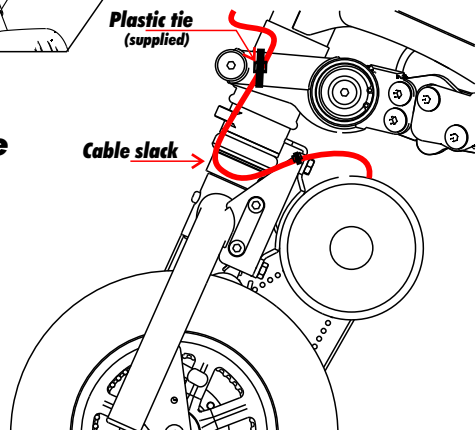

**5.3** - Connect the motor cable to the controller.

**5.4** - Tuck in the connectors inside the controller box, so they are not exposed.

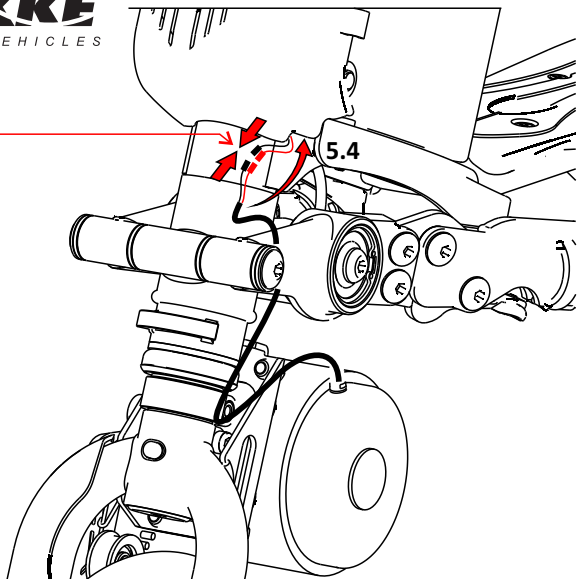

## **STEP 6** **Adjusting Brakes**

The brakes are pre-adjusted at the factory. If additional adjustment is needed, please refer to **BRAKE ADJUSTMENT** on page 21.

---

## **STEP 7** **Pre-ride Check**

- Make sure you correctly followed steps 1-6 for the proper assembly of your vehicle.
- Check all bolts that secure the fork and handlebars. Push forward and pullback on the handlebars strongly to verify they're secured.
- Make a final check of the brake by spinning the rear wheels. They should rotate freely until you apply the brakes. It must be possible to vigorously squeeze the brake levers without the brake levers touching the handlebars.
- Check the folding mechanism to ensure that the arms are locked in the riding position.
- Check the air pressure in all tires to meet the recommended levels (See page 20).

## **WARNING!**

Before riding the first time, please take a few minutes and review the Safety Riding Tips on pages 3-6 of this manual.

For the safety of friends and others who will try your new Colt it is your responsibility to guide them how to ride safely. Make sure you have read and understood all warnings and safety information contained in this owner's manual before riding. Please wear a safety helmet for riding.

# Vehicle Operation

## Parking

1. The Colt has parking brakes to keep it still and balanced. In the two manual brake levers there is a trigger that locks the actuated lever. Squeeze the brake lever all the way and pull the trigger with the index finger, then release the brake lever so the tension of the cable will keep the lock engaged. To release the parking brake, squeeze the brake lever and the trigger will jump and release from the locked position.
2. Preferably, find a flat surface for parking. If the parking spot is in an incline, point the front wheel up or down the slope. Do not park across the ramp.

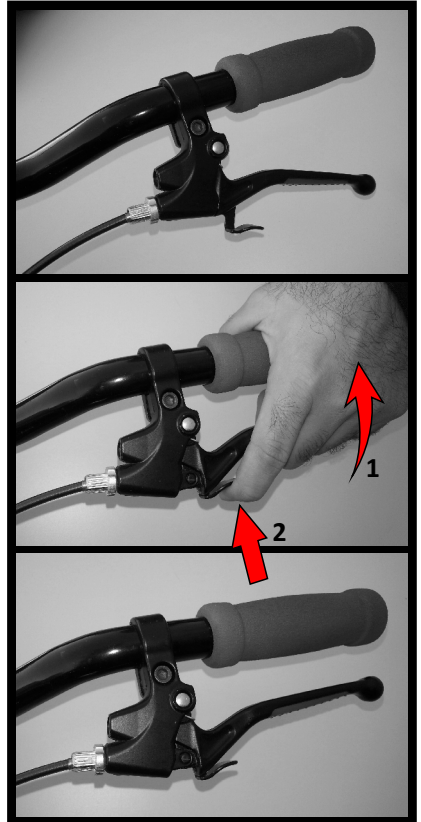
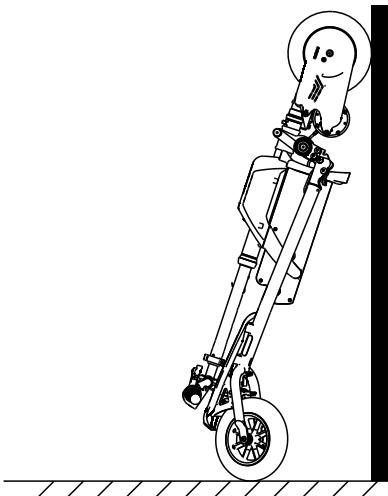

3. Try to find a shoulder or lip to rest the front wheel against, in order to prevent unexpected movement due to the incline. Lock the parking brakes for safety.
4. If the above methods do not work, fold your Colt and rest it against the wall or lay on the floor.

# Operation

## Riding Range

- A. The possible distance (miles) per ride of a Colt depends on many factors, including the topography of the terrain, rider's weight, throttle usage, assistance with body propulsion, tire type and pressure.
- B. To extend the riding range of the Colt avoid long or steep climbing, help the vehicle as much as possible with body propulsion and use the throttle sparingly and keep tires inflated to the recommended pressure.

## Installing/Removing the Battery

To install or remove the battery from the Colt it is necessary to identify the components to disconnect.

- A. Battery can remain installed on the Colt or removed for charging. Be careful to not drop the battery on the floor during installation and removal.
- B. On the bottom of the battery case, just below the ON/OFF switch is located the battery power connector. Carefully connect/disconnect before installing/removing battery.
- C. **Removal:** spread both wing brackets to disengage the locks. Pull the battery back.
- D. **Installation:** Sit the battery on the tray and slide it forward to engage the wing bracket to lock the battery case in place.

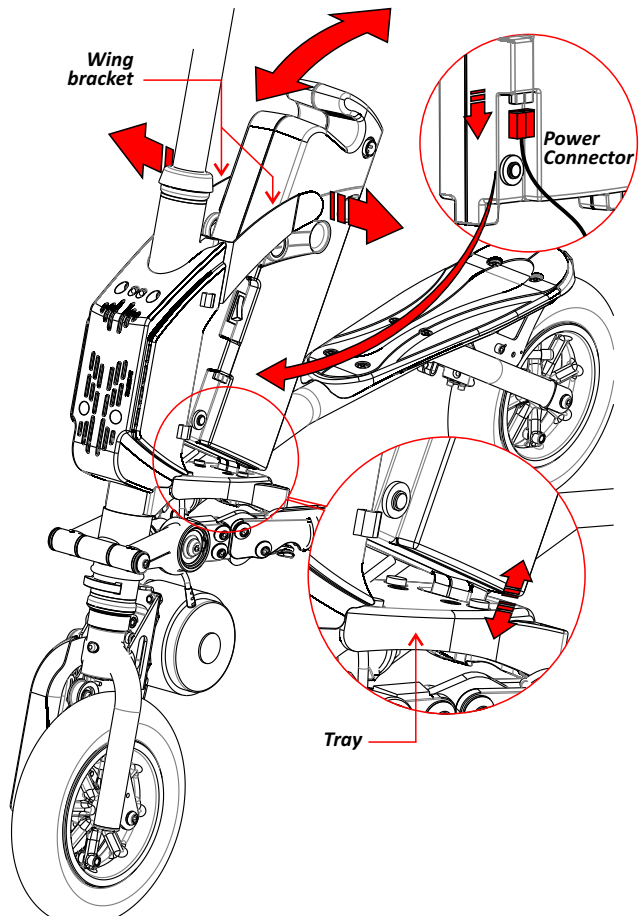



## **Charging the Battery**

- First time charge: charge for at least 12 hours.
- Usually, it will take 8 hours for a full charge.
- Do not exceed 24 hour charging time.
- Always charge the battery immediately after riding.
- Fully charge battery before storing for extended periods of time.
- Unplug charger from the wall outlet when not in use.
- Failure to recharge battery periodically may result in permanent damage and battery will no longer accept charge.

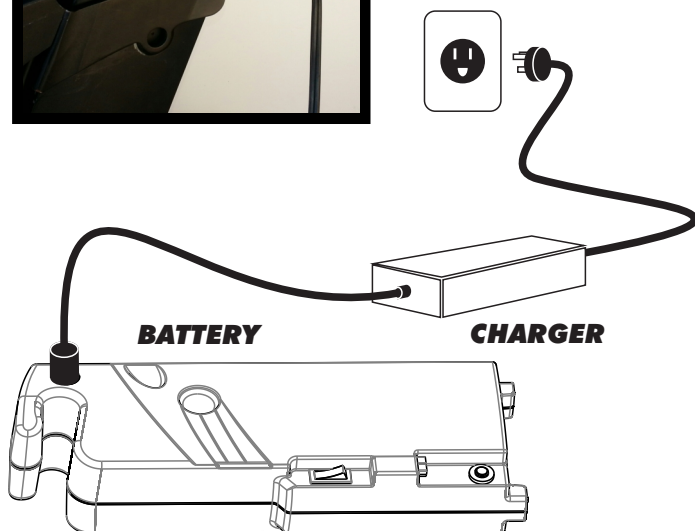

- Make sure the power switch is turned OFF when unit is not in use. Battery charge will drain when the switch is left ON and may discharge beyond a limit, and will not recharge.
- Never store the product in freezing or below freezing temperatures! Freezing will permanently damage the battery.
- Run time will vary with riding conditions: rider's weight, speed, tire pressure, wind, flat or hilly terrain. Constant start stop will shorten the riding range.
- Average battery life for a properly maintained unit is approximately 250 full charge/discharge cycles.

## ***Riding With Electric Power***

Once the battery is switched ON, the lights on the throttle will light up indicating the level of charge of the battery: full/half/low, meaning that the vehicle is ready to work. Gently twist the throttle grip backwards and the front wheel will start the movement of the vehicle. Control the amount of power to the motor by twisting the throttle back to increase power and returning it to decrease power.

If vehicle is left ON and inactive for over 5 minutes, the system will time out and shut OFF (to save energy). Even with the battery switched ON (red light on the battery ON), the throttle lights will turn OFF when system is timed out, and there won't be power delivered to the motor when twisting the throttle. You will need to reset the power by switching OFF and back ON to start the system.

When climbing inclines, if the speed becomes too slow (below walking speed), it indicates that the load is too heavy for the motor. Do not insist in riding in this condition as the motor will heat up and possibly get damaged. Try helping the motor by tackling the hill with side to side movements of the front wheel. Avoid any condition where the motor stalls under throttle.

In stall or overload condition the fuse may trip (the circuit will break and turn OFF the power from the battery to the system). You will have to wait for a while to allow the system to cool down and push in the fuse button to reset it.

## ***Charger***

When the charger is plugged to the wall outlet (120V) and connected to the battery, the status light will be lit RED indicating that the battery is charging up. When the battery becomes fully charged, the status light will turn GREEN.

## **Care and Disposal of the Battery**

Do not store in freezing or below freezing temperatures. Maintain your battery and ensure maximum battery life, carefully read above the “Charging Battery” section. The battery casing contains sealed Lead Acid batteries which must be recycled at their end life.

**EXHAUSTED or DAMAGED** batteries must be disposed in a recycling center, or alternatively, in a local seller of automotive batteries.

**DO NOT** dispose the battery in a fire. The battery may explode or leak corrosive acid.

**DO NOT** dispose the battery in your regular household trash. The incineration, land filling or mixing of sealed lead-acid batteries with household trash is prohibited by law.



# SAFETY WARNINGS

## **Safety Warning 1: RIDING ON A WET OR SLIPPERY SURFACE**

Avoid riding on wet or slippery surfaces (also surfaces covered by sand, gravel or mud) because the wheels may skid and braking distance can be affected causing loss of control and a possible crash. If necessary travel on slippery surface, try to travel in a straight line and avoid leaning the vehicle to maximize stability and control.

***Riding on wet surface, the braking distance will be increased significantly. Travel at lower speed and consider a longer distance and time to stop.***

## **Safety Warning 2: WEIGHT DISTRIBUTION**



When accelerating, it is important to place the weight on the front wheel, as shown in the picture, keeping most of your weight on your toes, feet positioned in front of the platform. This will ensure good traction of the front tire.

Once you and your Trikke EV are in motion, return to your normal posture. Be careful not to lean too far back or shift your weight behind the rear wheels. This warning is especially

important for drivers who do not have good coordination, or are slow to react to an unexpected event.

To brake more effectively, shift your weight back over your heels, over the rear wheels, as shown in the picture, but be careful not to lean too far back. Apply both brakes simultaneously (Trikke EV has independent brakes on rear wheels left and right respectively actuated by levers on the handlebars left and right). Distributing your weight evenly over each rear wheel is crucial for maximum braking efficiency. If you take the weight off of the platforms during braking you will cause the wheel to lose contact with the ground and lock.

The best way to ensure you are always well positioned and to minimize the risk of the vehicle pull a wheelie, is to distribute your weight evenly between the front and rear wheels, keeping your weight on your toes and putting your feet up to the front of the

Avoid leaning too far over the handlebars - the rider must maintain balance on their feet, not leaning on the handlebars. The legs should be slightly bent to absorb impact, balance the body and ensure constant contact with the platforms.

Avoid leaning your body back, supporting yourself on your heels, stepping behind the center of the rear wheels and pulling the handlebars back, because this way you will inevitably reduce the weight of the front wheel losing traction and control, and you may fall back and have an accident.

Another reason for a balanced weight distribution is to ensure a better use of traction (front and rear tires) with no spinning or skidding during acceleration and braking.

### ***Safety Warning 3: BEHAVIOR OF THE RIDER***

Proper use of the handlebars, and especially how to push it to the left and right is vital for your safety. Because the front wheel is designed to trail the fork, the handlebar tends to turn in the direction you tilt the vehicle. Unlike a bicycle, which tends to follow a straight line, the front wheel will actually accentuate the turn. Because of this condition, less experienced riders should pay special attention while driving. Turning the handlebars too far, and allowing the front wheel to move quickly to the side, may cause the vehicle to stop suddenly ("jack-knifing"), throwing the rider from the vehicle, which may cause injury. Always maintain firm control over the handlebars with both hands, never drive with just one hand or no hands. **The Trikke EV requires both hands on the handlebars at all times.**

Beginner riders have a tendency to apply excessive force on the handlebars, making sudden movements, throwing their weight from one side to another. What propels the Trikke forward manually is the leaning of the vehicle, a combination of turning and leaning of the steering column, and not just pushing the handlebars from side to side. It is better to think in terms of more leaning and less turning. Motion and trajectory in large "S" turns are best for beginners.

### ***Safety Warning 4: DOWNHILL***

As the Trikke EV is a totally new machine, with a unique handling, we recommend that you take time to familiarize yourself with the vehicle and to gradually explore the limits of performance with each ride.

This is especially important before attempting climbs or steep descents. Riding uphill and downhill are advanced and require you to be fully competent before even trying. On descents, we strongly recommend that you only go down slopes on which you can





control the speed by turning. Riding on hills at speeds that require constant braking are not recommended for three reasons: you can reach speeds where the braking distances needed are too long to stop you safely, and you may fall at high speed causing serious injury or death, and you will simply wear out the brake pads and rear tires long before their expected life expectancy.

The Trikke EV will accelerate quickly, so try to ride at speeds appropriate to your skill level.

### ***Safety Warning 5: SAFETY EQUIPMENT***

**ALWAYS USE SAFETY EQUIPMENT, ESPECIALLY A HELMET.** A helmet is essential when riding a Trikke EV or any exposed wheeled vehicle. We also recommend that you wear gloves, elbow and knee pads, especially children and inexperienced riders. Although it is a stable platform, there are always conditions that vary with the environment, which may surprise you, such as cracks in the pavement, sand, gravel, potholes, tree branches, people or other vehicles. Falls and accidents can occur.

Driving at night should be avoided, but in case of night time use we recommend the use of headlamps and signal lights on front and rear. See and be seen.

Also the use of horn or bell helps you call attention and be noticed.

***READ AND UNDERSTAND THE SECTIONS OF  
ASSEMBLY, MAINTENANCE AND SAFETY MANUAL  
BEFORE RIDING. ALWAYS FOLLOW THE INSTRUCTIONS  
AND READ ALL WARNINGS.***

Visit our website at [www.trikke.com](http://www.trikke.com) if you want to buy safety gear (helmet, gloves, knee and/or elbow pads).

## **Basic Maintenance**

### **Tires Pressure**

Tire pressure affects energy consumption and battery range. Lower pressure makes a smooth ride, but will require more energy due to increased rolling resistance. Higher pressure reduces rolling resistance and increases mileage, but it makes a bumpier ride. Do not run with very low pressure, as this can damage the tires, negatively affect braking efficiency and increase the risk of a fall. Particularly the front wheel (motor wheel) should not be calibrated with a pressure higher than recommended, as this can damage the engine due to the reduction in impact cushioning. Check the table below for the adequate air pressure.

The tires of the Trikke EV come with lower pressure from the factory, for transport reasons. You will have to pump the tires before riding. Do not exceed the recommended tire pressure.

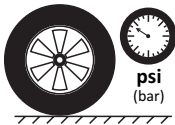

**TIRE PRESSURE:**  
**70-80 psi**

**WE RECOMMEND TO CHECK AND PUMP THE TIRES TO OPTIMAL PRESSURE EVERY 15 DAYS, USING A MANUAL OR SMALL ELECTRIC PUMP. MAKE SURE TO USE A PUMP WITH ACCURATE PRESSURE GAUGE.**

### **WARNING!**

**Do not use automated calibrator designed for large car tires. It may overinflate the tire in the process and cause the rupture of the tire or rim, with dangerous consequences.**

## Brake Adjustment

You can adjust the brake cable at the brake lever by turning the adjuster screw and locking the adjusted position with the locking nut (figure below). If you have already adjusted all the way out, you will have to stretch the brake cable at the brake pad, as follow:

1. Tires must be inflated to 80psi.
2. Turn the brake tension adjustment screws (at the lever) as far in or towards the brake-handle as they will go, so you will have room to adjust it later.
3. Place the vehicle upside down to access the brake system which is under the foot platforms at each rear wheel.
4. Loosen the 2 bolts that hold the brake cable to the pad.
5. Pull the cable towards the front (follow arrow) until the pad is close to the tire - leave a gap, so the wheel spins freely - 3 mm (1/8") - The desired result is to keep the brake pad as close to the wheel as possible without rubbing.
6. Tighten the 2 bolts back.

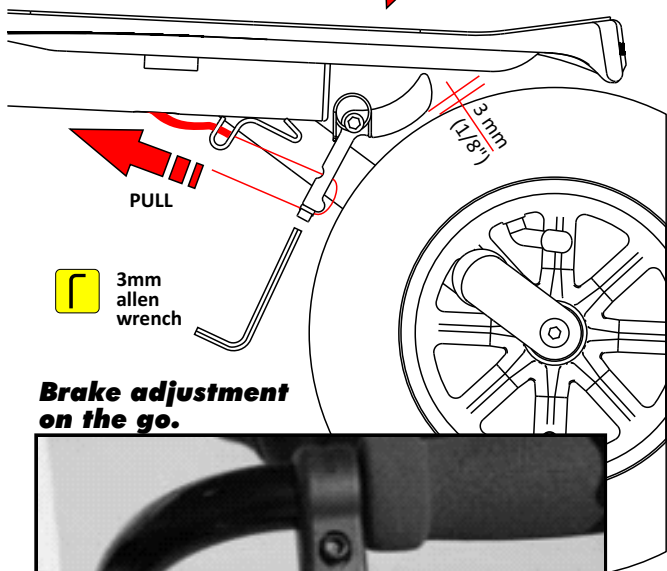
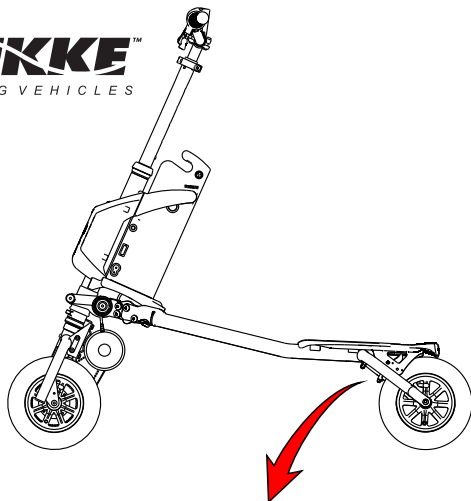

### Brake adjustment on the go.



**WARNING: brakes will work satisfactory when tires are inflated to proper pressure range.**

# Troubleshooting Electric Issues

	<b>CONDITION</b>	<b>POSSIBLE CAUSE</b>	<b>CHECK</b>
<b>DOESN'T WORK</b>	Battery on-off switch doesn't lights up when switched ON	Reset fuse	
		Battery is discharged	Check battery charge level (at power connector) with a voltmeter. 20-28V OK
	Battery on-off switch lights up but throttle doesn't	Battery connector disconnected	Check battery power connector
		Controller timed out	Battery on-off switch must be re-set. Turn it off then on.
	Battery on-off switch and throttle are lit, twisting throttle doesn't drive motor	Throttle, cable, connector	Check throttle cable and connector
		Motor, cable, connector	Check motor cable and connector
		Controller is damaged	Replace controller
<b>BATTERY DOESN'T CHARGE</b>	Charger light always green	Charger is damaged	Measure V at charger plug 29V OK
		Charger cable or connector damaged	Check cable and connector
		Wiring inside the battery case disconnected or broken	Open the battery case and check
		Damaged batteries	Check battery charge level (at power connector) with a voltmeter. 20-28V OK
	Charger light doesn't come on	Damaged charger or power cable	Try another power outlet. Try another charger.

## Specs

<b>BATTERY</b>	Quick-release removable box, 2x 12V-9Ah F2 (24V) lead-acid AGM non-spillable, on-off switch, circuit breaker.
<b>CHARGER</b>	AC 100 - 240V / DC 29V-1.0A
<b>MOTOR/TRANSMISSION</b>	FWD, DC brushed, chain drive, free-wheel.
<b>THROTTLE</b>	Half throttle, twist and go, with battery charge level lights.
<b>POWER</b>	250W - 24V
<b>SPEED</b>	Up to 13mph (21km/h)
<b>RANGE</b>	Up to 8 miles depending on terrain, speed, rider's weight.
<b>WHEELS</b>	Aluminum rims with high pressure air tires 8.5"x2", abec7 sealed bearing.
<b>BRAKES</b>	2 independent rear - scrub brake. Parking-lock brake levers.
<b>FRAME</b>	Hi-tensile steel, powder coat painting, foldable quick-release, 3CV cambering system, height adjustable handlebar.
<b>RIDER'S WEIGHT LIMIT</b>	200lbs (91kg) - suggested below 150lbs (68kg) for improved performance
<b>VEHICLE WEIGHT</b>	37lbs (17kg) - without battery 46lbs (21kg) - with battery
<b>MINIMUM RIDER'S AGE</b>	13 years old



## Basic Dimensions

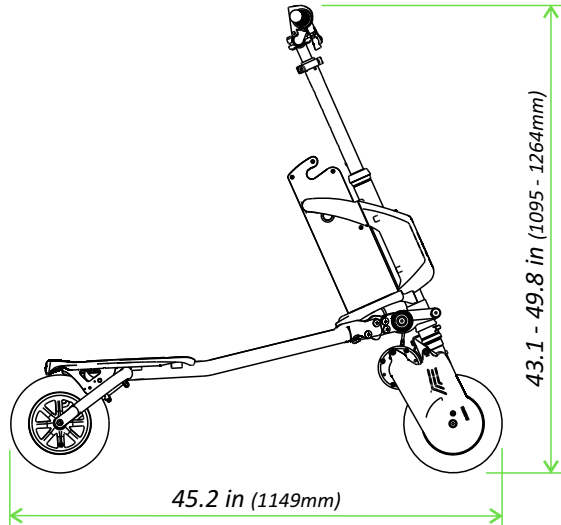
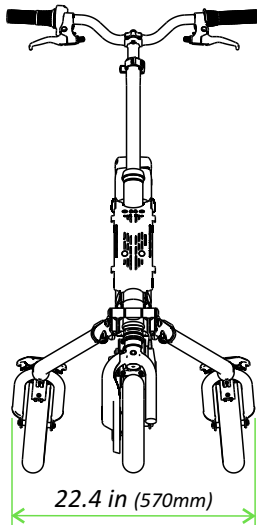

## Folded

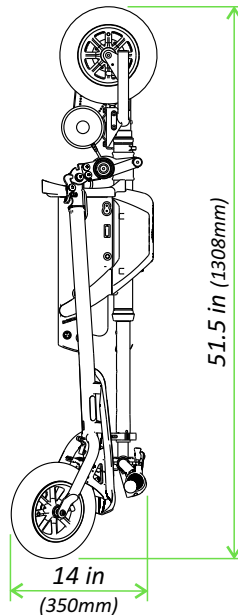
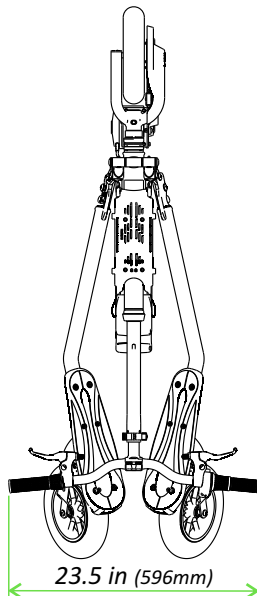

## **Other Vehicles by TRIKKE Tech**



**bpv**  
BODY POWERED VEHICLE

Trikke BPV are vehicles that use just body movement for propulsion. An excellent form of low impact exercise that involves the entire body while providing fun combined with transportation. This simple and elegant frame provides a stable 3-point platform that leans into the turn with the rider while all three wheels remain in contact with the ground for maximum stability. Riding is described as skiing on the streets.



**skki**  
SNOW SKI CARVING VEHICLES

With the Trikke SKKI, the rider simply leans the handlebars in the direction of the turn and the three ski blades draw the curves. It's much easier to learn comparing to skis or snowboard, and beginners are always going to have fun at the first attempt. A single vehicle can be shared by riders of different ages, sizes and levels of ability. Freedom to ski with no attachment or special boots! It is like driving a race car in the snow with total control.





Hi-performance  
Trikke EVs

***tritted***  
***Pon-e***

- **BLDC hub motor**
- **Higher power output**
- **Extended range**
- **Aluminum frame**
- **Lithium battery**
- **Disc brakes**



## ***Trikke EV Limited Warranty***

Subject to the following limitations, terms and conditions, Trikke Tech, Inc. ("Company") warrants to the original owner of each new vehicle Trikke™ Trikke EV ("Vehicle") that the vehicle when new is free from defects in material and workmanship. This warranty is valid for the Term listed below, from the date of purchase from the Company or an authorized dealer or representative. This warranty is conditional on the vehicle being operated under normal use and properly maintained according to the plan established by Owner's Manual. This warranty is void if the vehicle has not been purchased from an authorized Trikke dealer, not followed the periodic maintenance in accordance with the plan, or for abuse or misuse. The Owner's Registration Card must be completed at the time of purchase by dealer and a Warranty Certificate will be issued to the first owner. If the vehicle frame breaks due to faulty materials or workmanship within the warranty period, the vehicle may be replaced subject to the Conditions of Guarantee. If any part do not function properly due to defects in material or workmanship during the warranty period, this piece will be repaired or replaced at the discretion of the Company, subject to the warranty conditions below.

### ***Warranty Term***

Frame and parts: **12 months**

Electrical parts (battery, motor, controller, throttle): **90 days**

Parts subject to wear and tear: (tires, tubes, brake, handgrips, decks): **30 days**

### ***Warranty Conditions***

This Limited Warranty is made only to the original owner of the new Vehicle purchased from Company or an authorized dealer or representative, and it shall remain in force only as long as the original owner retains ownership of the Vehicle. This Limited Warranty is not transferable.

This Limited Warranty is issued to the original owner of a brand new vehicle purchased from the Company or an authorized dealer or representative, and shall remain in force as long as the original owner retains ownership of the vehicle. This Limited Warranty is not transferable. In order to exercise its rights under this limited warranty, the warranty must be submitted during the warranty period, to the company or one of its authorized representatives, along with the sales invoice or other documentary proof of purchase. The owner will be responsible for costs related to return and delivery of the vehicle to the Company or its authorized



reseller. Under no circumstances this warranty covers the cost of shipping the vehicle to the dealer. The Company will cover the cost of labor and parts necessary to repair the vehicle warranty. This limited warranty does not apply to normal wear or of any defects, malfunctions or failures resulting from abuse, neglect, damage caused accidentally or deliberately, exceeding weight limits, improper operation, improper maintenance, alteration, collision, accident or misuse or abuse. The vehicle was NOT conceived, designed, distributed, manufactured or sold for use in stunts, jump ramps, jumps, drive aggressively, use on uneven terrain or off road, submersion in water, use in harsh climates, loaded over the weight limit, commercial activities, or any similar activities. Such uses may damage the vehicle, can cause serious injury to the rider, and in all cases will void this warranty. The user assumes all risks of physical injury, vehicle breakdown, loss or personal injury caused to third parties or related to the use of the vehicle.

### ***Product Life Cycle***

The Trikke™ Trikke EV vehicle has a lifecycle. The duration of this cycle varies with the maintenance and care received during their time of use, and the type and amount of use that the vehicle is subjected. The vehicle must be inspected periodically by observing indicators of fatigue and other indicators of potential problems. These are very important safety checks to help prevent accidents, injuries to the rider and shortening the lifecycle of the vehicle.

THIS IS AN INTEGRATED AND FINAL STATEMENT OF TRIKKE'S LIMITED WARRANTY. COMPANY DOES NOT AUTHORIZE OR ALLOW FOR ANYONE, INCLUDING ITS AUTHORIZED DEALERS OR REPRESENTATIVES, TO EXTEND ANY OTHER WARRANTIES, EXPRESS OR IMPLIED. NO OTHER REPRESENTATION AND NO STATEMENT OF ANYONE BUT THE COMPANY, INCLUDING A DEMONSTRATION OF ANY KIND BY ANYONE, SHALL CREATE ANY WARRANTY REGARDING THE TRIKKE CAMBERING VEHICLE. ALL OF THE REMEDIES AVAILABLE TO THE ORIGINAL OWNER ARE STATED HEREIN.

IT IS AGREED THAT TRIKKE TECH, INC.'S LIABILITY UNDER THIS LIMITED WARRANTY SHALL BE NO GREATER THAN THE AMOUNT OF THE ORIGINAL PURCHASE PRICE AND IN NO EVENT SHALL TRIKKE TECH, INC. BE LIABLE FOR INCIDENTAL OR CONSEQUENTIAL DAMAGES.

## **DISCLAIMER**

All other remedies, obligations, liabilities, rights, warranties, express or implied, arising from law or otherwise, including but not limited to, any claimed implied warranty of merchantability, any claimed implied warranty arising from course of performance, course of dealing or usage of trade, and any claimed implied warranty of fitness, are disclaimed by Company and waived by the original owner.

Some states, jurisdictions, countries, do not allow some or all of the limitations set for herein, or the exclusion or limitation of incidental or consequential damages. If any provision is found unenforceable, only that provision shall be stricken and all others shall apply. This limited warranty does provide the original owner with certain legal rights and recourse and the original owner may possess other rights or recourse, depending on the state, jurisdiction, country or province.

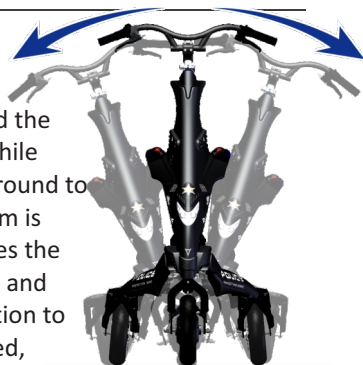

The unique 3CV technology developed by Trikke Tech uses a mechanism that allows the Trikke EV frame to cambering and the suspension to adapt to the the surface and lean into turns while keeping three points of support always in contact with the ground to ensure optimal stability at any speed. This camber mechanism is

elegantly simple and provides the necessary rigidity, geometry and assistance to the rider's motion to allow a greater control, speed, comfort, durability and above all the full confidence of riding.



### Patent & Trademark Information

The Trikke EV vehicle is a product developed, patented and property of Trikke Tech, Inc. protected by the following International Patents:

U.S. 6,220,612, 6,499,751, 6,827,358, 6,976,687; 1235709 Europe, Canada 2,390,224; China ZL 00 8 18040.7 - Other patents pending.

**TRIKKE** and Trikke EV are trademarks of Trikke Tech, Inc.

### Contact Information

Most inquires can be addressed by the authorized dealer, distributor and service center. You can also find additional information on our website with product information, accessories, videos, photos and more. If you don't find the replacement part on our website, please contact Trikke Tech via e-mail at [tech@trikke.com](mailto:tech@trikke.com).

### Trikke Tech, Inc.

85 Industrial Way - suite F

Buellton, California USA 93427

Phone: 805-693-0800 fax: 805-693-0811



This manual and its contents are the property of Trikke Tech, Inc.

No portion of the text or images in this manual can be reproduced without the prior written permission of Trikke Tech, Inc.

Copyright © 2014 Trikke Tech, Inc.

All Rights Reserved 2014





## **WARNINGS**



- **READ AND UNDERSTAND** THE ASSEMBLY MAINTENANCE AND SAFETY SECTIONS OF THE OWNER'S MANUAL BEFORE RIDING THE TRIKKE™ CAMBERING VEHICLE. ALWAYS FOLLOW THE INSTRUCTIONS AND PAY ATTENTION TO ALL WARNINGS.
- **ALWAYS WEAR PROPER SAFETY EQUIPMENT WHEN RIDING THE TRIKKE CAMBERING VEHICLE**, INCLUDING AN ANSI, SNELL, CPSC, ASTM, OR DIN EN 1078 APPROVED HELMET. WEAR PROPER FOOTWEAR AND SECURE LACES BEFORE RIDING.
- **AVOID WATER, BUMPS, GRAVEL, SAND, CRACKS, UNEVEN SURFACES OR OBSTACLES** THAT MAY STOP YOU SUDDENLY OR CAUSE YOU TO LOSE CONTROL. THE TRIKKE ELECTRIC VEHICLE IS NOT INTENDED FOR OFF-ROAD USE AND AVOID RIDING AT NIGHT.
- **DO NOT LEAN HEAVILY ON THE HANDLEBARS.** RIDER'S WEIGHT MUST BE MOSTLY ON IT'S FEET. EXCESSIVE WEIGHT ON THE HANDLEBAR IS UNSAFE AND CAN RESULT IN LOSS OF CONTROL AND POSSIBLE FALL, IF THE FRONT WHEEL NEEDS TO BE TURNED SHARPLY OR HITS AN OBSTACLE ON THE GROUND.
- **USE BOTH HANDS TO HOLD THE HANDLEBARS FIRMLY AT ALL TIMES.** ONE-HANDED OR HANDS FREE RIDING IS EXTREMELY DANGEROUS. DO NOT PUSH TOO HARD ON OR APPLY UNEVEN PRESSURE TO EITHER SIDE OF THE HANDLEBARS. DO NOT MAKE SUDDEN SHARP TURNS OR APPLY YOUR BODY WEIGHT TO THE HANDLEBARS WHEN TURNING. SUCH ACTIONS MAY CAUSE THE VEHICLE TO "JACK-KNIFE" OR TO STOP SUDDENLY WHICH CAN CAUSE SERIOUS INJURY TO THE RIDER.
- **DO NOT LEAN BACK OR PULL BACK ON THE HANDLEBARS.** DOING SO CAN CAUSE THE RIDER TO FALL OFF THE BACK OF THE VEHICLE POSSIBLY RESULTING IN SERIOUS INJURY OR EVEN DEATH. RIDER MUST KEEP ITS WEIGHT WITHIN THE AREA DELINEATED BY THE 3 WHEELS.
- **DOWNHILL RIDING IS NOT RECOMMENDED, SPECIALLY FOR NOVICE RIDERS.** THE TRIKKE ELECTRIC VEHICLE IS DESIGNED PRIMARILY FOR USE ON FLAT, DRY PAVEMENT. RIDING DOWN STEEP HILLS OR DOING PROLONGED DOWNHILL RIDES IS NOT RECOMMENDED. PROLONGED USE OF THE BRAKES CAN CAUSE THE BRAKES TO OVERHEAT AND DRAMATICALLY REDUCE THE REAR TIRES TO WEAR DOWN PREMATURELY, DRAMATICALLY REDUCING THE EFFECTIVENESS OF THE BRAKES OR EVEN CAUSING THEM TO FAIL. EXTREME CAUTION SHOULD ALWAYS BE USED WHEN RIDING ON ANY HILL.
- **ALWAYS INSPECT THE VEHICLE BEFORE EACH RIDE** AND MAKE SURE THAT THE HANDLEBAR, QUICK RELEASE AND FOLDING MECHANISMS ARE SECURELY LOCKED IN THE PROPER RIDING POSITION. READ THE ASSEMBLY SECTION OF THE OWNER'S MANUAL FOR IMPORTANT ASSEMBLY AND MAINTENANCE INFORMATION.
- **TEST THE BRAKES FOR PROPER FUNCTION BEFORE EACH RIDE.** ALWAYS APPLY BOTH BRAKES EVENLY WITH YOUR WEIGHT DISTRIBUTED EVENLY OVER EACH REAR WHEEL.
- **CHILDREN SHOULD ALWAYS BE SUPERVISED BY AN ADULT WHEN RIDING.** IT IS THE RESPONSIBILITY OF THE PARENT OR GUARDIAN TO PROPERLY MAINTAIN AND INSPECT THE VEHICLE BEFORE EACH RIDING SESSION BY A CHILD. THE Trikke EV CAMBERING VEHICLE IS NOT RECOMMENDED FOR CHILDREN UNDER 13 YEARS OF AGE.
- **ALWAYS EXERCISE EXTREME CAUTION** WHEN YOU ARE RIDING IN CLOSE PROXIMITY TO OTHER VEHICLES, PEDESTRIANS, AND ESPECIALLY TO CARS IF YOU ARE RIDING ON A STREET. BE SURE TO OBEY ALL RULES OF THE ROAD. PLEASE BE COURTEOUS TO OTHER RIDERS AND PEDESTRIANS WHO MAY BE SHARING THE PAVEMENT WITH YOU.
- **DO NOT MODIFY YOUR Trikke EV VEHICLE.** ONLY USE TRIKKE TECH, INC. APPROVED PARTS AND ACCESSORIES. SEE THE LIMITED WARRANTY FOR USE RESTRICTIONS.
- **WE RECOMMEND THAT YOU NOT EXCEED THE RECOMMENDED RIDER WEIGHT RESTRICTION** OF 200 LBS. OR 91 KG.



**TRIKKE™**  
ELECTRIC VEHICLES

**colt**



[trikke.com](http://trikke.com)

**TRIKKE™**